

Next level security for retail operations.

radionix
G SERIES

PROTECT

Seriously protective.

For companies serious about protecting their team, space, and assets, the G Series control panel goes beyond sounding an alarm to next-level security you can feel—day and night. It's your business partner in protection, designed to seamlessly connect and integrate every component of your alarm system with round-the-clock monitoring, instant alerts, and control in the palm of your hand.

From the moment you open your doors to the last person leaving and every hour overnight, the G Series is seriously protective. For safety beyond intrusion, trust beyond compare.

SAFETY FIRST

Secure all areas and access points.

When it comes to managing the security of retail operations, the responsibilities are endless. From the moment you open your doors to the final sale of the day, securing your retail space, people, and profits is a full-time job.

That's why the G Series is your true partner in protection — minimizing shrink loss, maximizing your operations, and keeping your teams and customers safe. We work around the clock to ensure there are no blind spots when it comes to entryways, equipment, and merchandise.

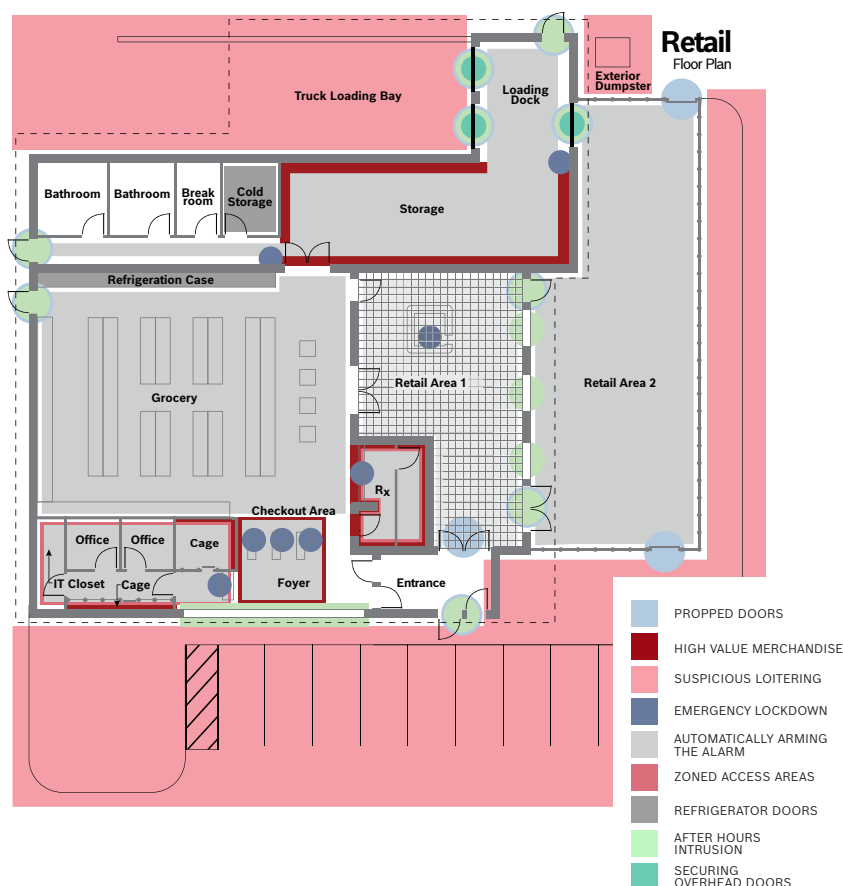

SCENARIOS

How our intrusion systems, cameras, control panels, and alarms fill gaps in security.



PROPPED DOORS

The control panel can be programmed to tell when the door has been open too long, keeping the perimeter secure.



HIGH VALUE MERCHANDISE

The drawer or cabinet can be programmed to detect when it has been left open too long, sending alerts to designated staff.



SUSPICIOUS LOITERING

Our intrusion systems combined with our cameras can be programmed to detect if a person is outside too long or where they aren't allowed.



EMERGENCY LOCKDOWN

Panic buttons can be carried by personnel or placed in a fixed, discrete location. They can signal a silent alarm, a call for help, and/or initiate a lockdown.



AUTOMATICALLY ARMING THE ALARM

When it comes to setting or resetting alarms, the only way to ensure they're not inadvertently forgotten is to have them automatically arm themselves.



ZONED ACCESS AREAS

Areas like the pharmacy, cash office, managers' offices, stock room, and employee break room need secure access management.



REFRIGERATOR DOORS

The panel can be programmed to alert staff if the door is left open too long, reducing product loss due to spoilage.



AFTER HOURS INTRUSION

Our alarm system will detect an intrusion, immediately producing an audible alert at the source and sending multiple notifications to key personnel.



SECURING OVERHEAD DOORS

Door contacts connected to the control panel can be programmed to alert staff if the door is left open longer than necessary.

radionix
G SERIES